

Low-pressure multiway cock Medium-pressure multiway cock



For direct flange connection to pressure and differential pressure transmitters

Low-pressure multiway cock U 1

- To shut off process connections, to check the transmitter zero, and to check the transmitter characteristics

Medium-pressure multiway cock U 2

Medium-pressure multiway cock U 3

- To shut off process connections, to check the transmitter zero and to blow out the process lines

Technical data

Low-pressure multiway cock U 1

The low-pressure multiway cock has 3 settings: "operation", "zero check" or "off" and "characteristic check" or "off". In the operating position the process connections are connected to the pressure or differential pressure transmitter. In the "zero check" position this connection is interrupted and the two measuring chambers of the pressure or differential pressure transmitter are connected together. In the "characteristic check" position, test pressure can be applied to each measuring chamber separately.

Medium-pressure multiway cock U 2 Medium-pressure multiway cock U 3

The medium-pressure multiway cocks have 4 settings: "operating", "zero check" or "off", "blow out line 2" and "blow out line 1". In the operation position the process connections are connected to the pressure or differential pressure transmitter. In the "zero check" position this connection is interrupted and the two measuring chambers of the pressure or differential pressure transmitter are connected together. In position "blow out line 2" or "blow out line 1" the respective line is opened to the atmosphere so that any condensate or contamination in the lines can be blown out.

Mounting

We recommend using the attachment set provided for mounting the pressure or differential pressure transmitter. If the mounting bracket is used, the transmitter needs not be fixed otherwise.

Low-pressured multiway cock U 1

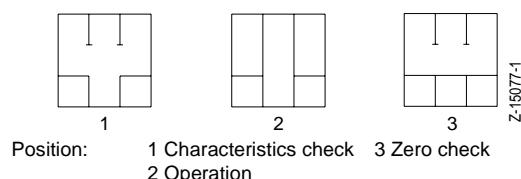

Medium-pressure multiway cock U 2 / U

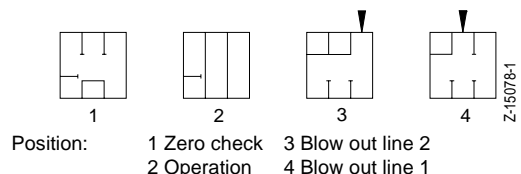

Operating curve of cocks U 2 and U 3

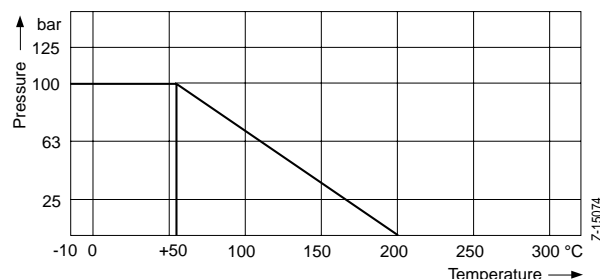

	Low-pressure multiway cock U 1	Medium-pressure multiway cock U 2	Medium-pressure multiway cock U 3
Construction	Case with turning plug	Drop-forged case with turning plug	
Operating pressure	Max. 25 bar	Max. 100 bar	
Operating temperature	-10 °C...+ 60 °C	-10 °C...+60 °C, briefly 200 °C, see operating curve Fig. 3	
Nominal size	DN 5	DN 5	
Materials	Case of hotpressed brass (CuZn39Pb3) Plug of corrosion-resistant steel X5 CrNi 1810, Mat. No. 1.4301 Mounting eyes of corrosion-resistant steel, X5 CrNiMo 17122, Mat. No. 1.4401 Sealing bush PTFE	Case of steel, C 22,8, bronzed Plug of corrosion-resistant steel X5 CrNi 1810, Mat. No. 1.4301	Case of corrosion-resistant steel X6 CrNiMoTi 17122, Mat. No. 1.4571 Plug of corrosion-resistant steel X6 CrNiMoTi 17122, Mat. No. 1.4571
Connections	2 screw fittings, heavy duty, galvanized steel for solderless pipe connection to DIN 2353 for precision steel pipe 12 Ø, and flange connection to DIN 19213 for connection transmitter.	3 screw fittings, heavy duty, phosphatized steel	3 screw fittings, heavy duty, corrosion-resistant steel Mat. No. 1.4571
Attachment set	Consisting of: 1 mounting bracket, galvanized steel 4 socket-head hex screws, 7/16-20 UNF UNF × 1 1/8", galvanized steel 2 sealing rings, diameter 17.7 × 24, PTFE 1 hex key 3/8"		
Adapter set	2 nozzles, 12 diameter (brass, CuZn39Pb3) for mounting in the pipe fittings, suitable for flexible tubing with 8 mm internal diameter 2 reducers 12/6 mm (galvanized steel) for alternative connection of flexible tubing or pipe with 6 mm outer diameter 2 support sleeves (brass) for mounting plastic tubes with 6 mm outer diameter		

Dimensional drawings (dimensions in mm)

Low-pressure multiway cock U 1

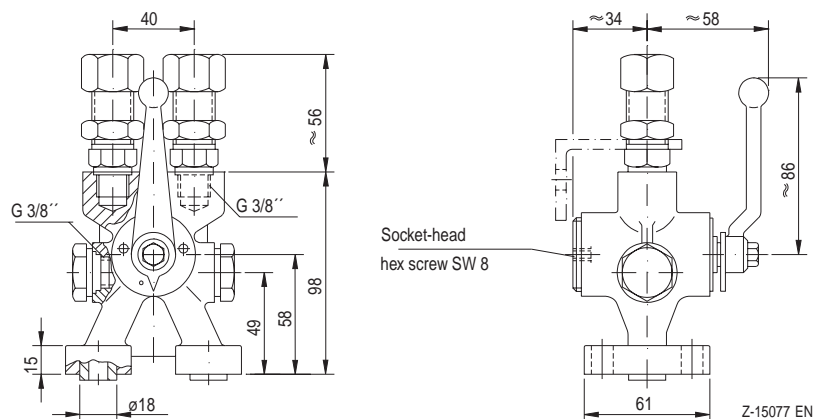

Medium-pressure multiway cock U 2 / U 3

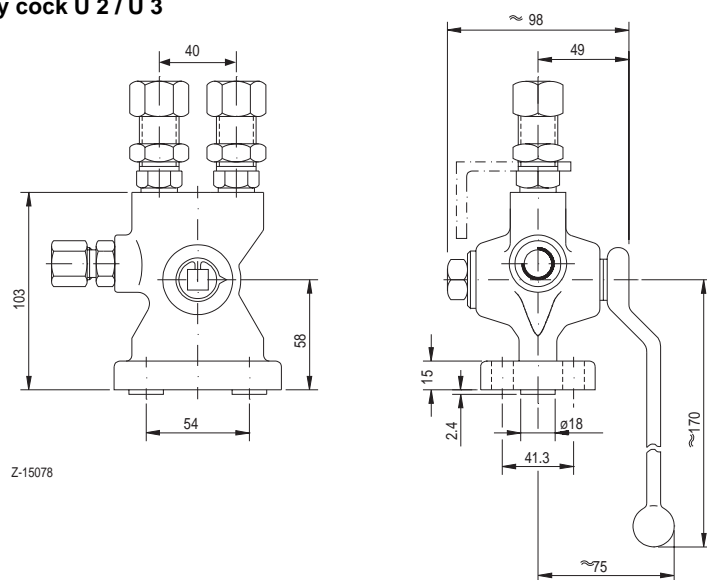

Mounting bracket

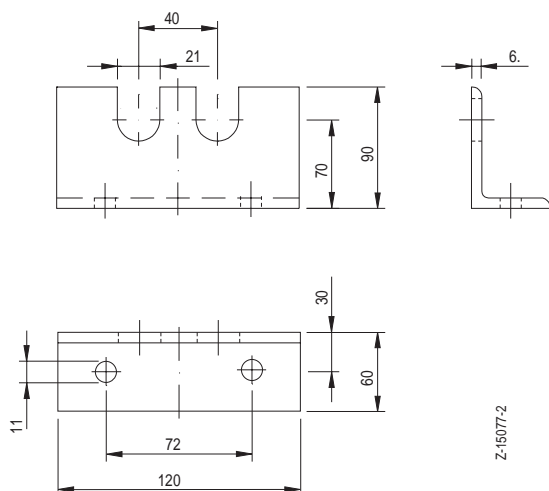

Multiway cocks for direct flange connection to pressure and differential pressure transmitters

10/14-5.36 EN

Ordering information				
Multiway cock for direct flange connection to pressure and differential pressure transmitters			Catalog No.	
Type	Dimens. drawing	kg approx.		
Low-pressure multiway cock U 1	fig. 1	3	14920-2821231	
Medium-pressure multiway cock U 2	fig. 2	4	14920-2821234	
Medium-pressure multiway cock U 3	fig. 2	4	14920-2821235	
Attachement set for mounting on the transmitter			14920-2821237	
Adapter set			14920-2821233	

Contact us

ABB Ltd.

Process Automation

Howard Road, St. Neots
Cambridgeshire, PE19 8EU
UK

Phone: +44 (0)1480 475321

Fax: +44 (0)1480 217948

ABB Inc.

Process Automation

125 E. County Line Road
Warminster PA 18974
USA

Phone: +1 215 674 6000

Fax: +1 215 674 7183

ABB Automation Products GmbH

Process Automation

Schillerstr. 72
32425 Minden
Germany

Phone: +49 551 905-534

Fax: +49 551 905-555

www.abb.com

Note

We reserve the right to make technical changes or modify the contents of this document without prior notice. With regard to purchase orders, the agreed particulars shall prevail. ABB does not accept any responsibility whatsoever for potential errors or possible lack of information in this document.

We reserve all rights in this document and in the subject matter and illustrations contained therein. Any reproduction, disclosure to third parties or utilization of its contents – in whole or in parts – is forbidden without prior written consent of ABB.

Copyright© 2011 ABB

All rights reserved

3KXP700004R1001

10/14-5.36-EN 01.2011