

MCCB Migration

Tmax T – T3 to Tmax XT – XT3

Tmax XT, the next generation of molded case circuit breakers from ABB, is now available. The Tmax XT offers increased capacities for interrupting ratings and voltages as well as application versatility with new trip units, accessory and mounting options; all in a compact and easy to use package. This guide has been created to assist with the migration of the existing Tmax T series of breakers to the new Tmax XT series. For more detailed information, please consult the Tmax XT technical catalog.

Tmax T – T3



Tmax XT – XT3

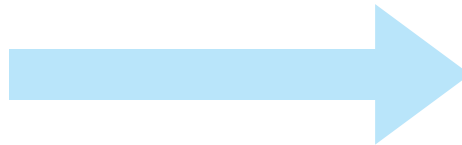

T3	Frame	XT3
225A	Amperage	225A
3p & 4p	# of Poles	3p & 4p
80% all, 100% fixed	Rating	80% all, 100% fixed
25, 35	kA @ 480V AC	25, 35
10, 10	kA @ 600Y/347V AC	10, 10
25, 35	kA @ 500V DC	25, 35
TMF, MCS, MCP	Trip Units	TMF, MCS, MCP
F, P	Versions	F, P
4.13" x 2.75" x 5.9"	Dimensions (3p F WxDxH)	4.13" x 2.75" x 5.9"

Benefits of XT3

- Push-in electrical accessories for rapid, tool-free installation
- Expanded termination options, including: front, Cu or CuAl lugs, extended front, extended spread and multi-cable
- Increased signaling versatility with a maximum capacity of six changeover contacts plus one bell alarm per breaker and 600V options

To configure and price a Tmax XT or other ABB circuit breaker, please use the online configurator tool at:
www.abb.us/lowvoltage-configurator

Panel mounting comparison – fixed version, 3p

T3 overall dimensions

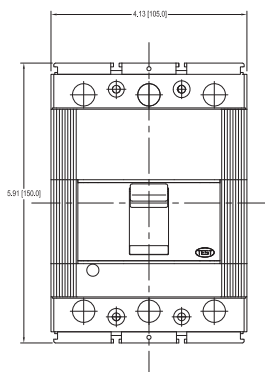

XT3 overall dimensions

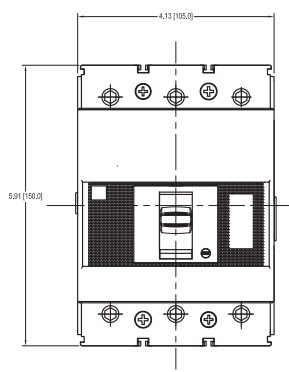

T3 mounting holes

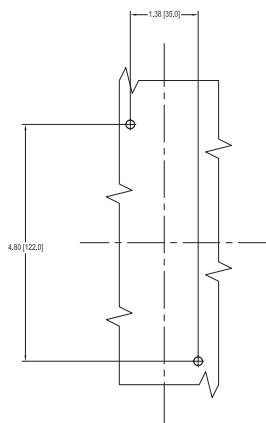

XT3 mounting holes

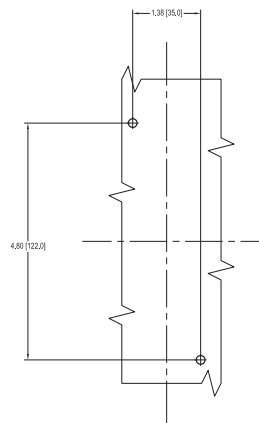

Contact us

ABB

Low Voltage Products
8155 T&B Boulevard
Memphis, TN 38125
www.abb.com/lowvoltage

USA Technical Support: 888-385-1221
Customer Service: 888-862-3290
7:00 a.m. to 5:30 p.m., CST, Monday – Friday
lvps.support@us.abb.com

Power and productivity
for a better world™

