

FH 200

System pro M compact®

GB Operation and assembly instructions

CE

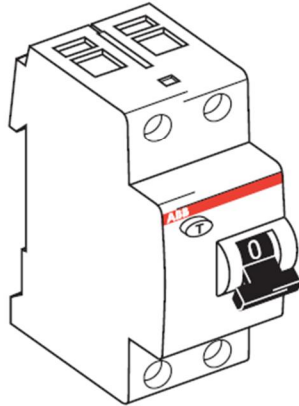

2CSF 423 002 D0202

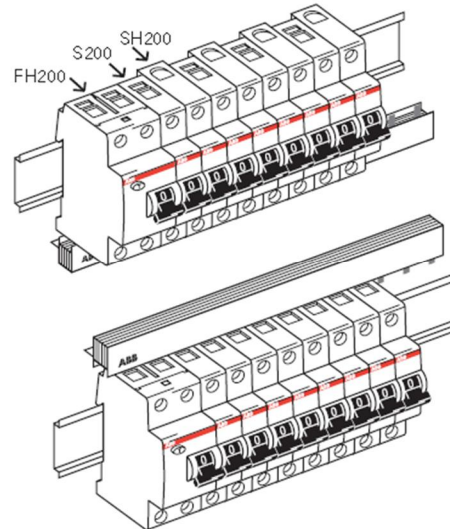

1

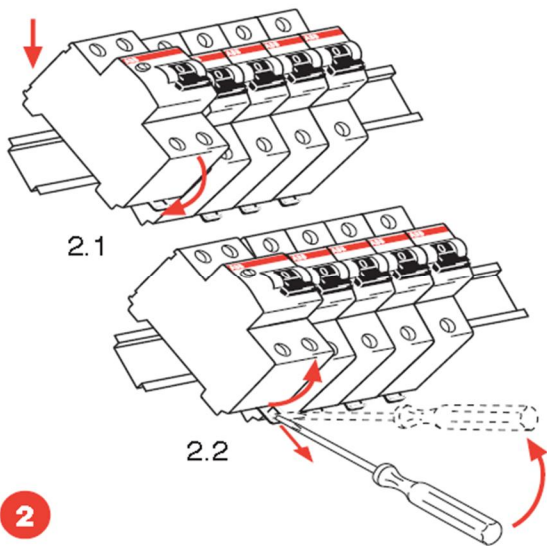

2

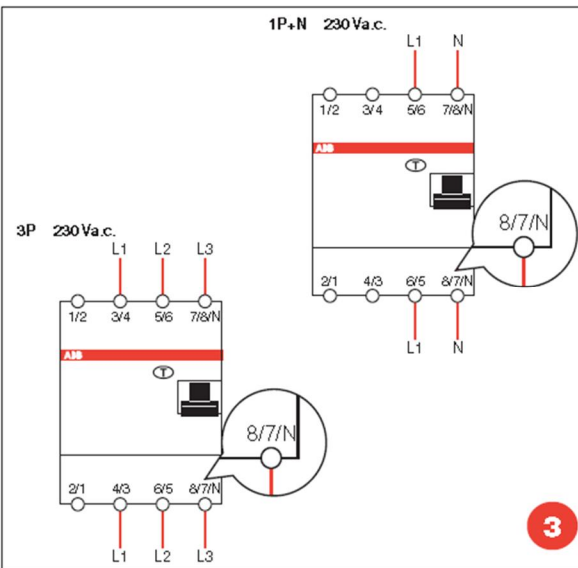



3

ABB

Technical data

See equipment plate data and refer below:

FH200 AC	Alternate currents 
FH200 A	Alternate currents, pulse currents with DC components 
Insensitivity to transient current pulses with wave-form 8/20 μ s:	FH200 AC, FH200 A up to 250A
Co-ordination with Short Circuit Protection Device :	6 kA, with 63A fuse type gL 500V
Protection against overcurrent :	The RCCBs must be used with Short Circuit Protection devices to provide circuit protection against overloads and short circuit faults.

Power supply

The devices can be fed from either the upper or lower terminals.

Assembly

Designed for fitting on symmetrical DIN rail to standard EN 60715, 35mm. width, with fast clip included in the breaker.

It is possible to realize the wiring with System pro M compact connection busbars on both the upper and lower terminals (see figure 1) with S200 and SH200 series MCBs.

Figure 2: Assembly on DIN rail (2.1). Removal (2.2).

Electrical connections

In a three-phase network with neutral ($U_n = 230/400V$ a.c.- $127/230V$ a.c.), all line wires, included the neutral one, should be connected (excluded the protection wire).

The wires should be firmly connected in the terminals: maximum torque moment according to EN 61008/IEC 61008 standards.

It is also possible to use a four-pole RCCB in single-phase networks and three-phase networks without neutral (see figure 3) .

Instructions for the user (to be kept available for future users as well).

Remember to press the "T" test button at least every six months. The RCCB should trip. If this does not happen, an authorized electrician should be alerted immediately because the system safety has been reduced.

Always call a qualified technician to carry out any work on fixed or mobile electrical installation.

Environment protection

- The product is conforming to the european standards 2002/95/CE regarding the restrictions on the use of certain dangerous substances in the electrical and electronical equipments.
- It is necessary to respect the local regulations concerning the elimination of the packaging materials and of the circuit-breaker and, if possible, to recycle them.

