

**ABB parts**  
Available as option +C135. Also separately available for ACX580-01 IP21 and IP55 with ordering codes:  
3AXD50000105311(R1), 3AXD50000105328 (R2), 3AXD50000105335 (R3).

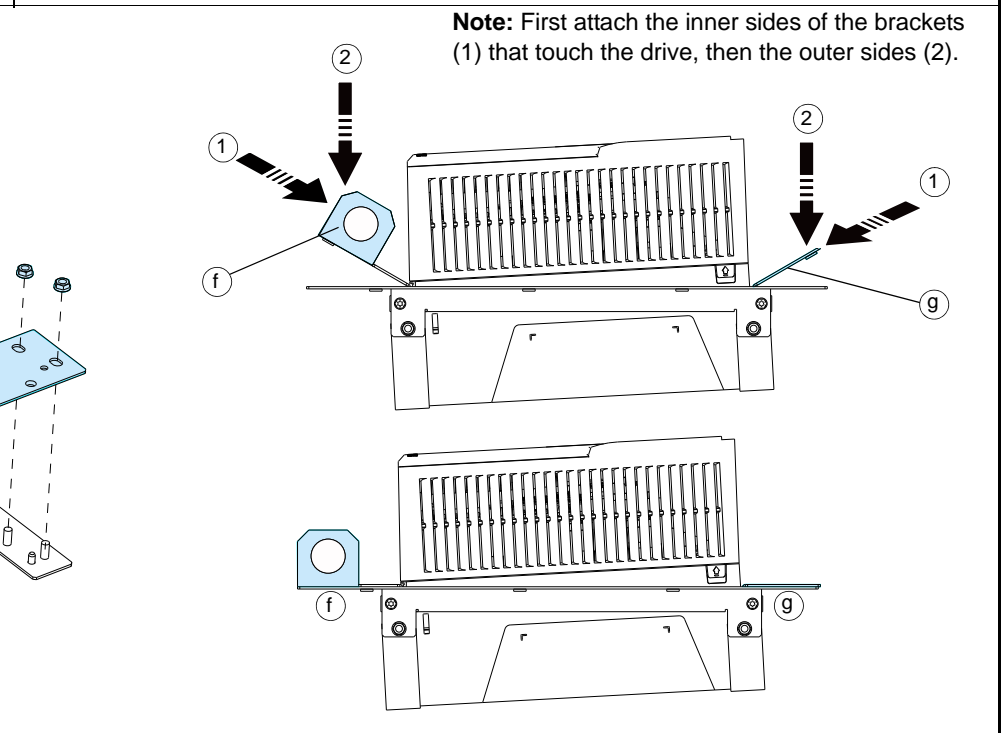

8

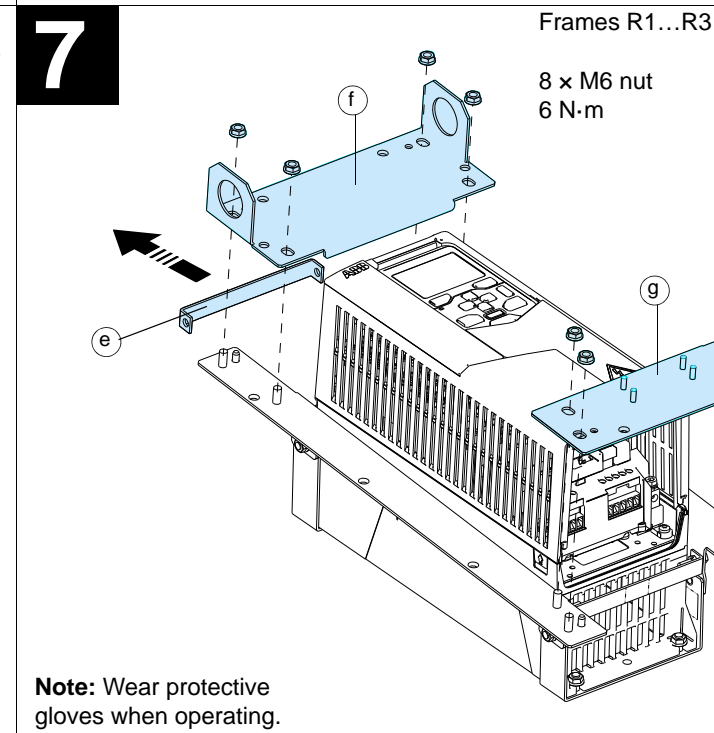
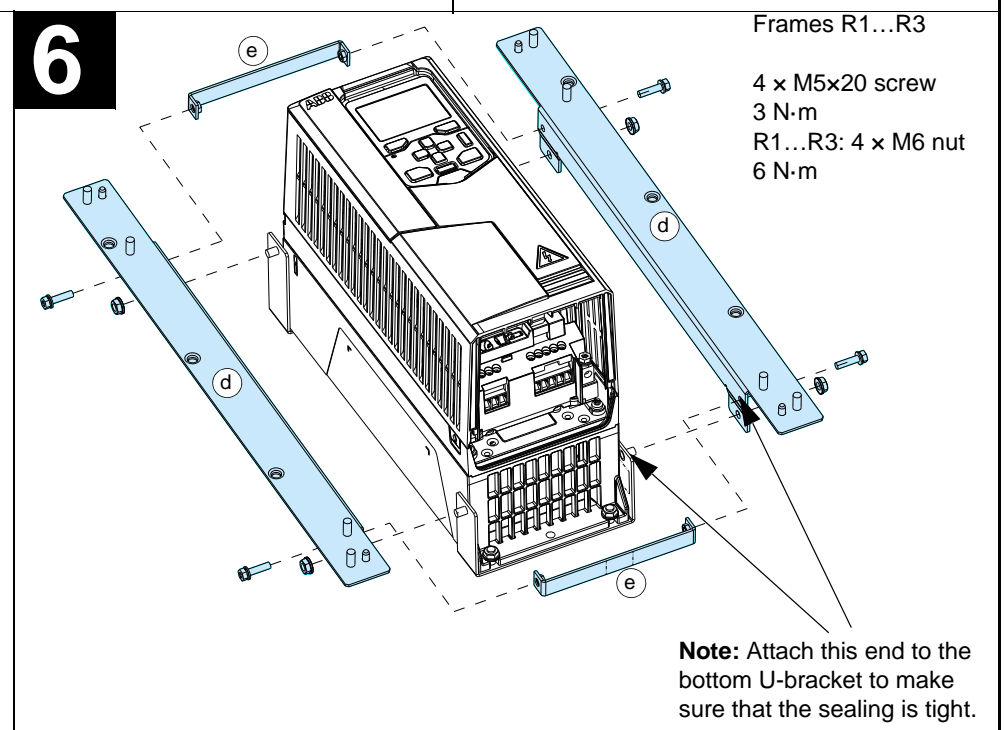
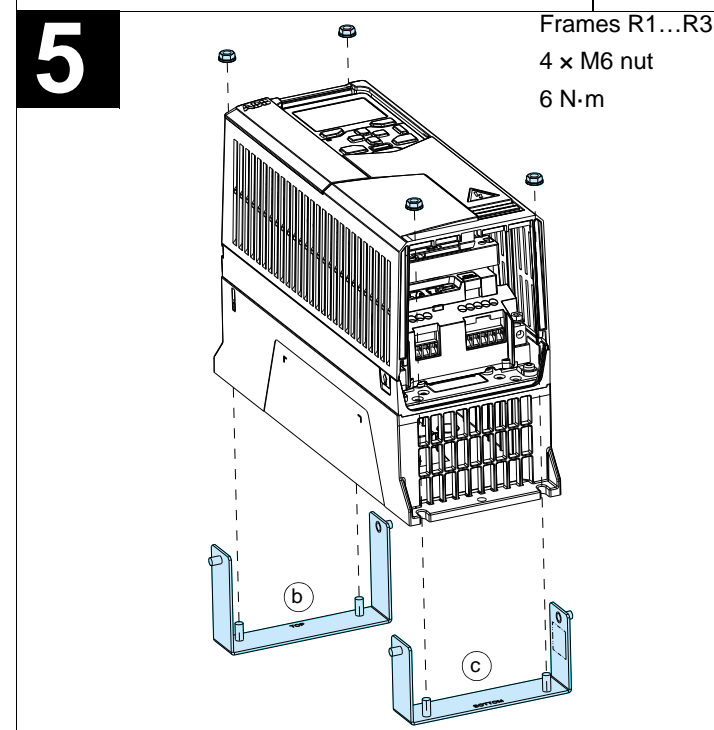
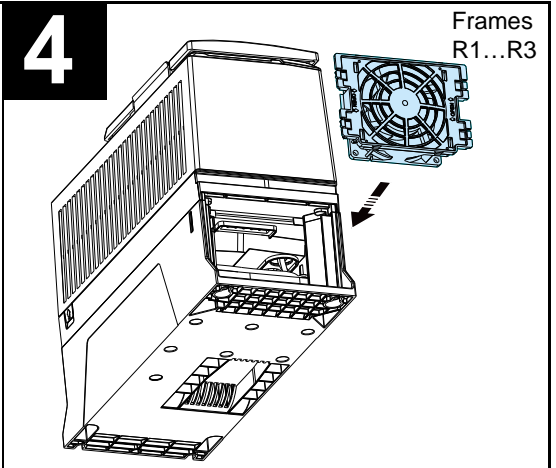
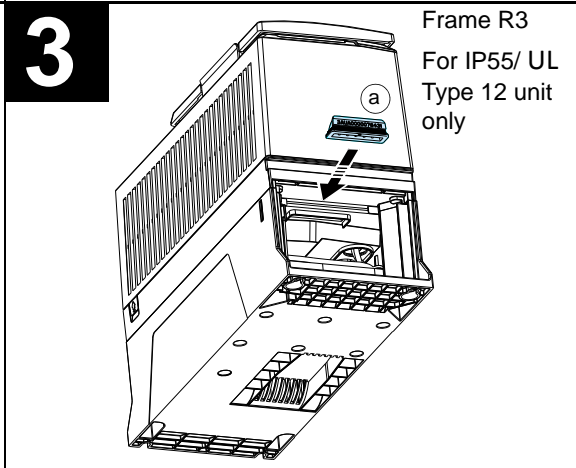
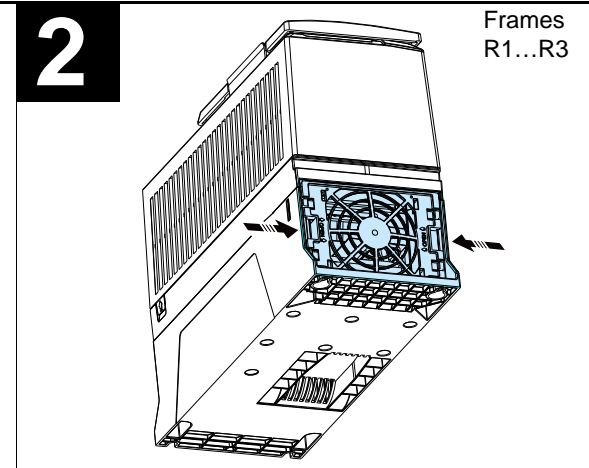
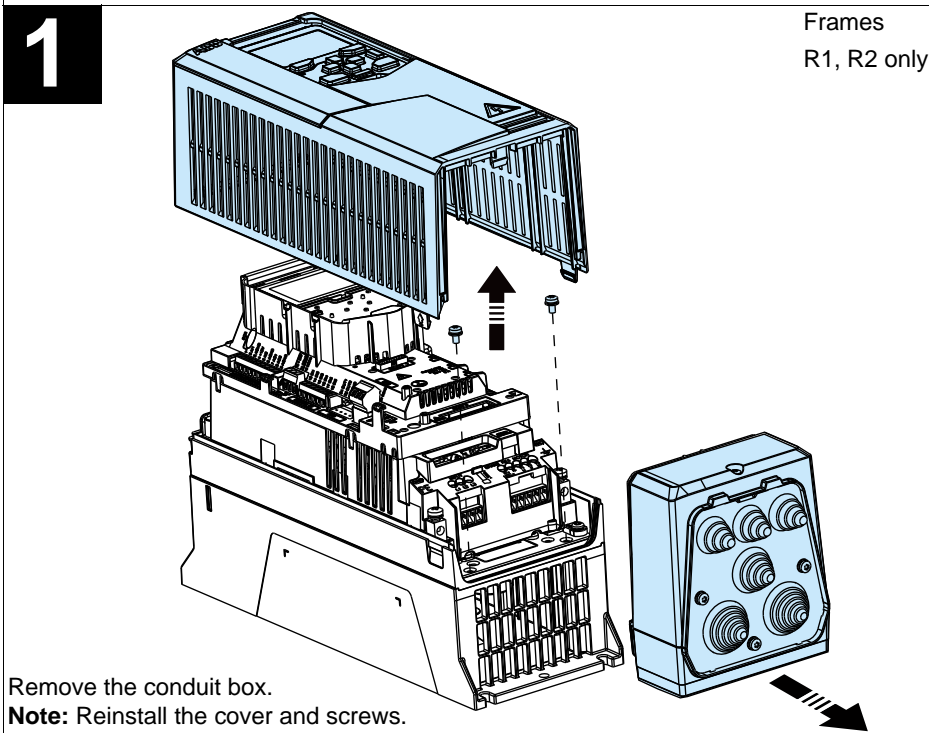
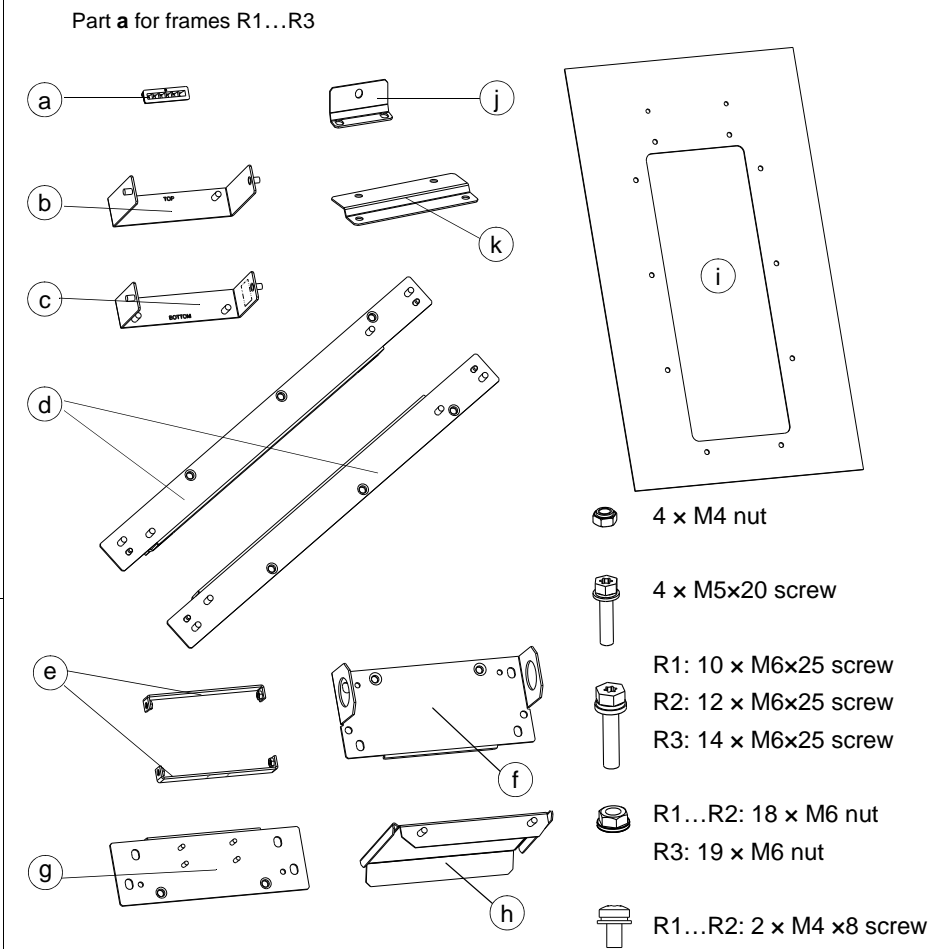
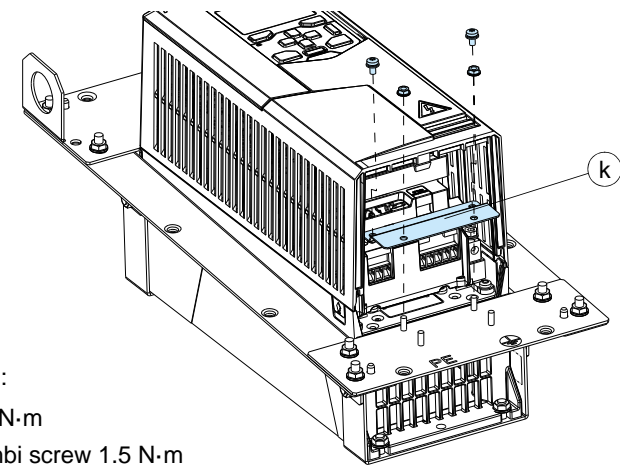

Frames R1...R2:  
2 x M4 nut 1.5 N·m  
2 x M4 x 8 Combi screw 1.5 N·m

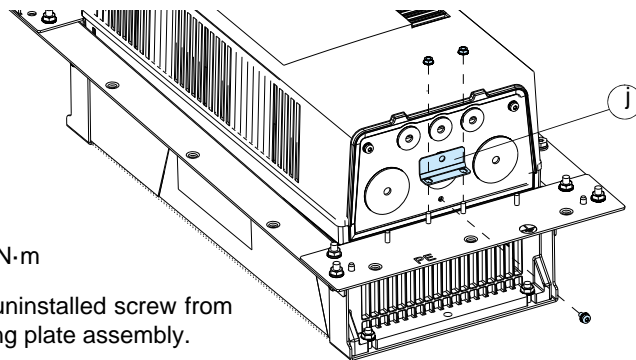

Frame R3:  
2 x M4 nut 1.5 N·m

**Note:** Use the uninstalled screw from drive for grounding plate assembly.

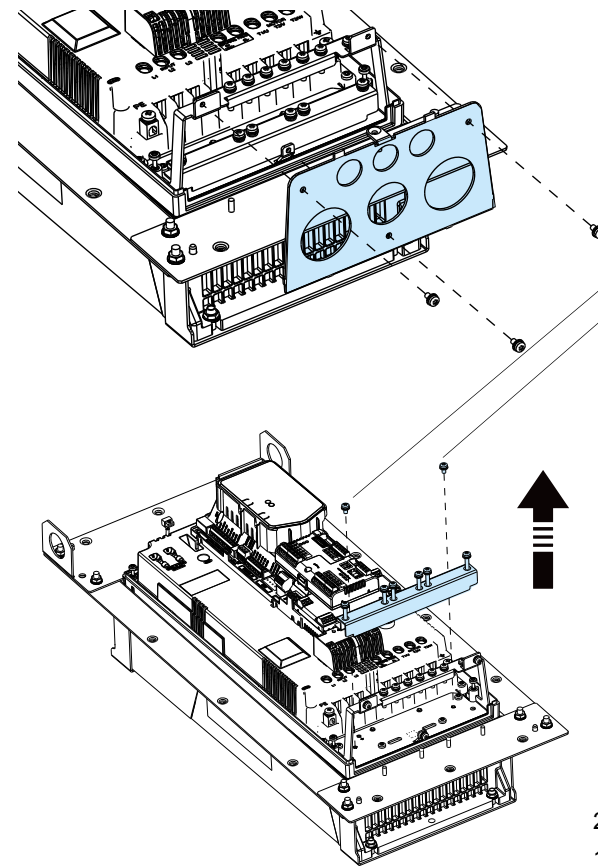

Optional steps

**Note:** Frame R3 is shown as an example.  
The cable shelf varies in different frame sizes.

**Note:** Reinstall the screws to avoid moisture  
exchange through the empty holes!

1.5 N·m

2 x M4 nut  
1.5 N·m

9

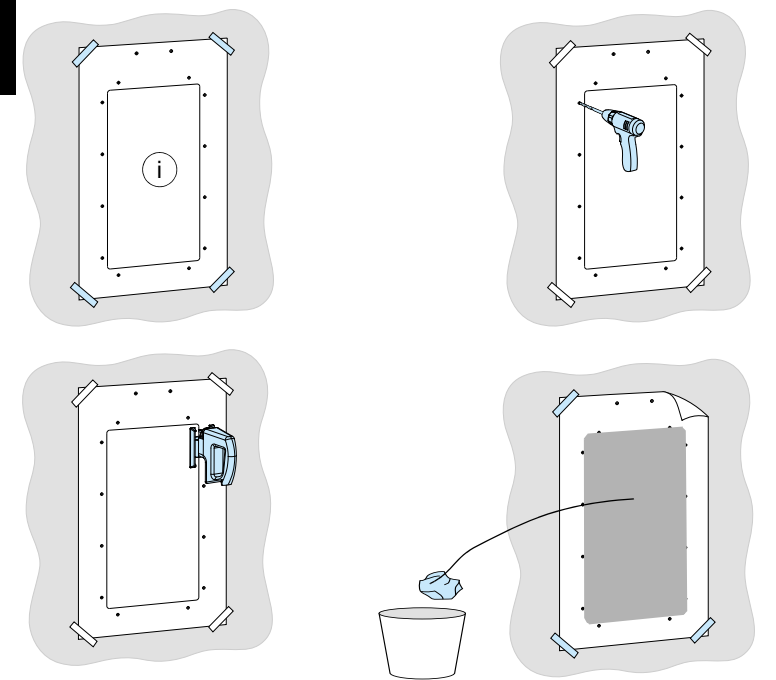

Drill holes for M6 Rivet or Kalei nuts. Consider the hole size for the nuts.  
Rivet/Kalei nuts are not included in the delivery.

**Note:** Mounting templates are different (size, number and position of holes) for  
different frame sizes.

10

Frames R1...R2:  
2 x M6 nuts

Frames R3:  
3 x M6 nuts  
6 N·m

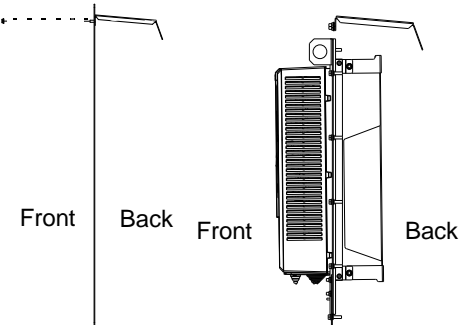

**Note:** UL Type 12  
is fulfilled on the  
drive backside  
when the flange  
and hood are  
installed.  
Step10 is not  
required for IP55.

Back

For more information, see *Flange mounting kit installation supplement*  
(3AXD50000119189 [English]). Go to [www.abb.com/drives](http://www.abb.com/drives)

[ACS580-01 manuals](#) [ACH580-01 manuals](#) [ACQ580-01 manuals](#)



11

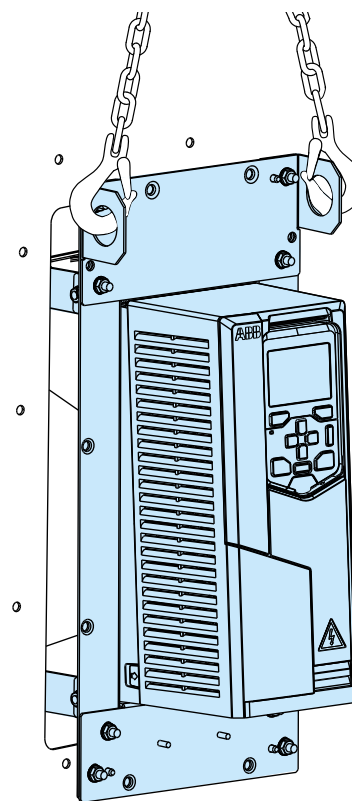

12

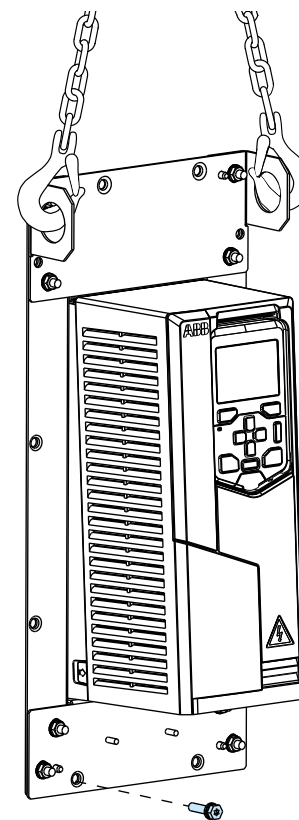

1 x M6x25 screw  
6 N·m

13

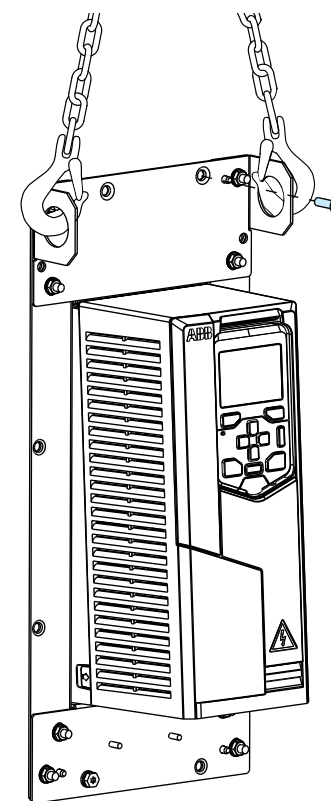

1 x M6x25 screw  
6 N·m

14

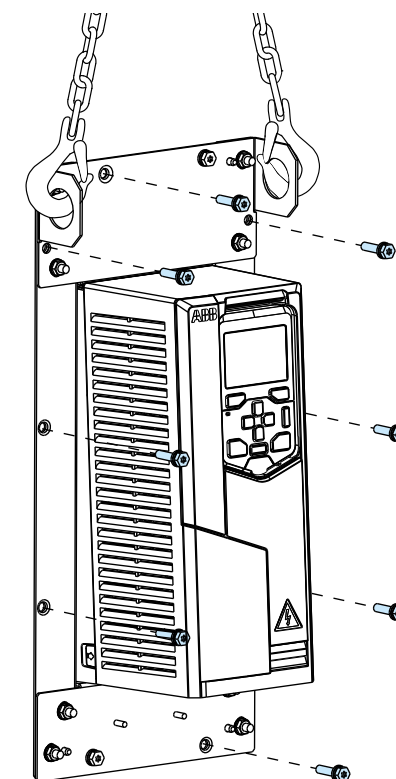

R1: 8 x M6x25 screw  
R2: 10 x M6x25 screw  
R3: 12 x M6x25 screw  
6 N·m

15

