



ABB AG – Calor Emag Medium Voltage Products

# Gas-insulated switchgear Type ZX0.2

# Gas-insulated switchgear Type ZX0.2



Medium voltage switchgear  
Type ZX0.2

Single busbar systems

12 kV, ...2500 A,...31.5 kA

24 kV, ...2500 A,...31.5 kA

36 kV, ...2500 A, ...31.5 kA

# Gas-insulated switchgear Type ZX0.2

With IAC  
classification  
AFL 31.5 kA 1s  
AFLR 31.5 kA 1s

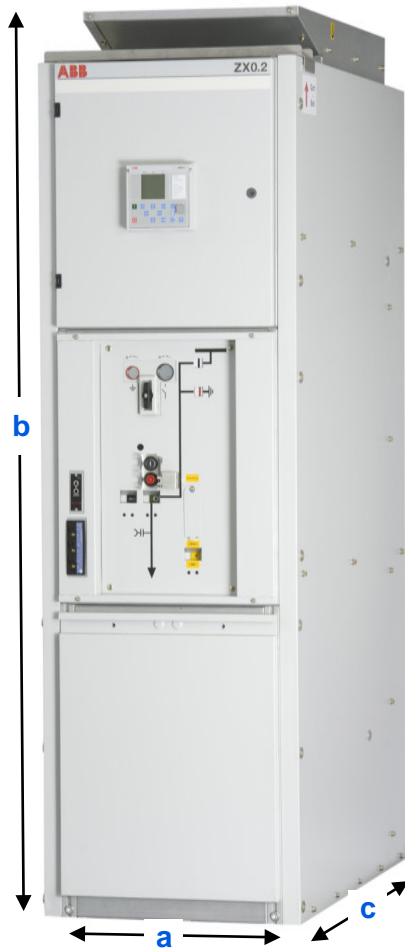

Rated voltage	kV	12	24	36
Rated current of busbars	A	...2500	...2500	...2500
Rated current of tee-offs				
with circuit-breaker	A	...2500	...2500	...2500
with switch-disconnector/ fuse combination	A	...80	...63	-
Rated short-circuit breaking current	kA	...31,5	...31,5	...31,5
Width <b>a</b>	mm	450 / 600 / 1200 <sup>1)</sup>		
Height <b>b</b>	mm	2400		
Depth <b>c</b>	mm	1330		

<sup>1)</sup> Dependent on current

# Gas-insulated switchgear Type ZX0.2



ZX0 individually partitioned  
for extended application range

- Up to 36kV rated voltage
- Currents up to 2500A for busbars and incoming feeders
- Short-circuit currents up to 31.5 kA for all voltage levels
- Local manual operation of all switching devices
  - Optionally also with remote control
- Suitable for any protection or control device
- Replacement of a panel in the row without gas work

# Gas-insulated switchgear Type ZX0.2

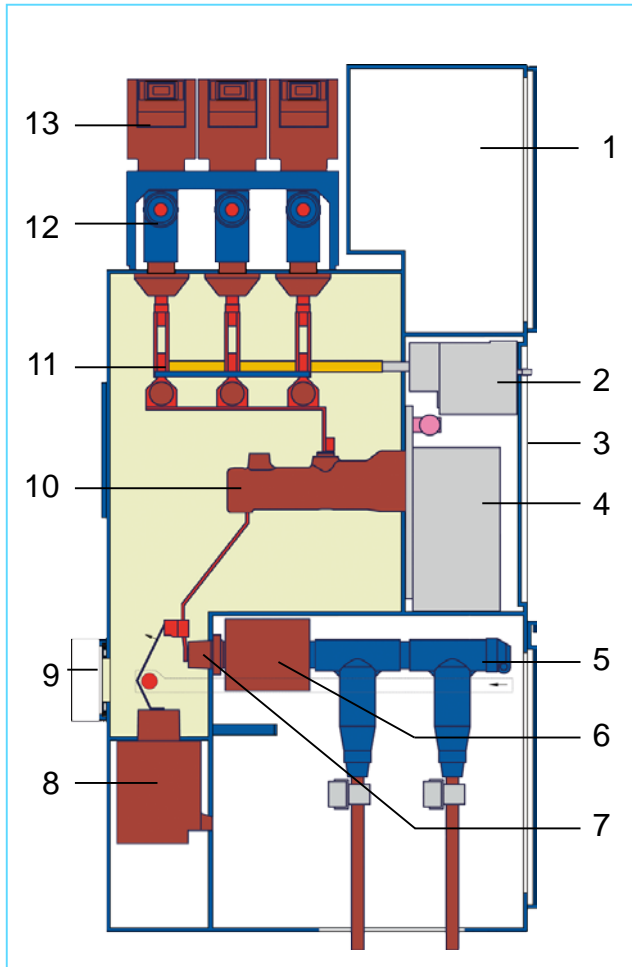

## Circuit-breaker panel, 1250 A

- 1 Removable low voltage compartment
  - 2 Three position disconnector operating mechanism
  - 3 Mechanism bay with operator controls
  - 4 Circuit-breaker operating mechanism
  - 5 Cable connector
  - 6 Window-type current transformer
  - 7 Bushing with outer cone
  - 8 Isolatable voltage transformer on the cable
  - 9 Pressure relief disk
  - 10 Vacuum circuit-breaker
  - 11 Three position disconnector
  - 12 Busbars
  - 13 Plug-in busbar voltage transformers
- SF<sub>6</sub>

# Gas-insulated switchgear Type ZX0.2

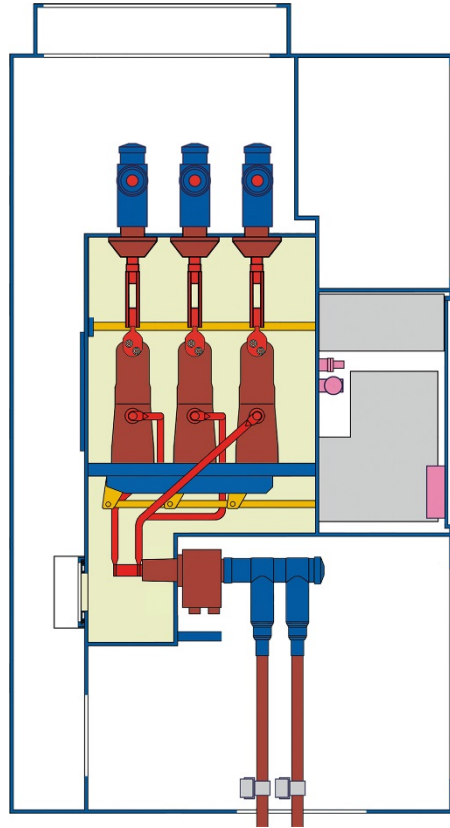

## Panel variant

- Circuit-breaker panel 630A up to 24kV

# Gas-insulated switchgear Type ZX0.2

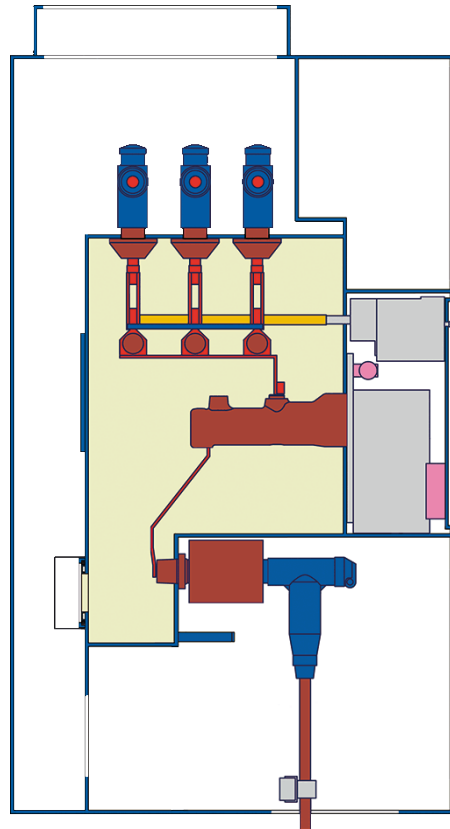

## Panel variants

- Circuit-breaker panel  
630A / 1250A for all voltages

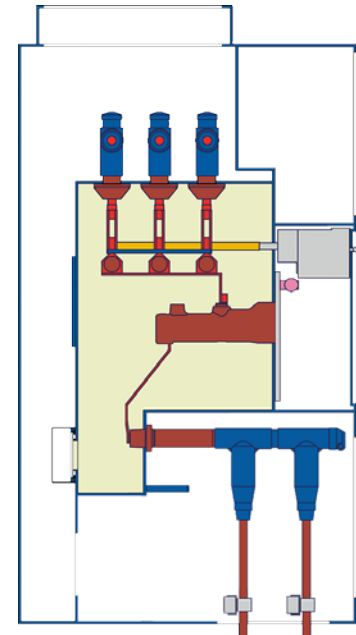

- Cable termination  
panel 630A / 1250A

# Gas-insulated switchgear Type ZX0.2

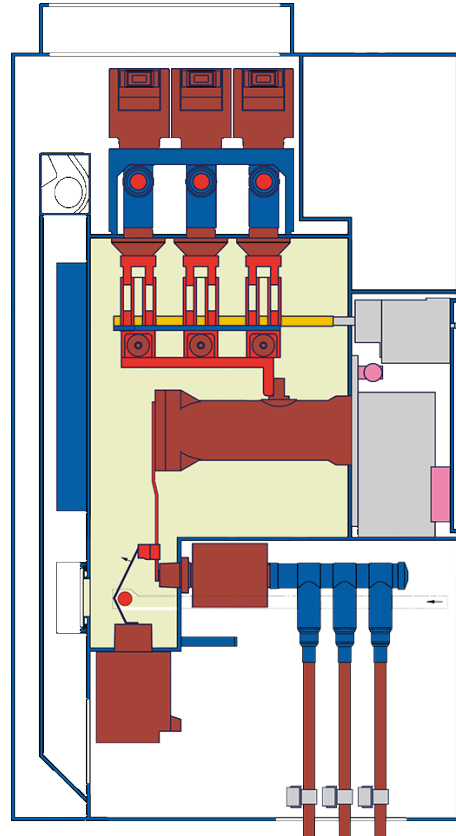

## Panel variants

- Circuit-breaker panel 2500A

## Similarly for

- 1600A
- 2000A

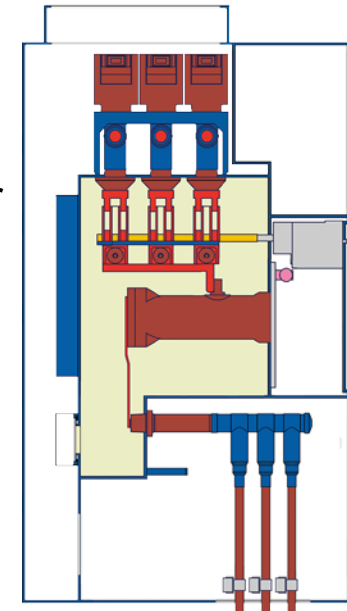

- Cable termination panel 2500A



# Gas-insulated switchgear Type ZX0.2

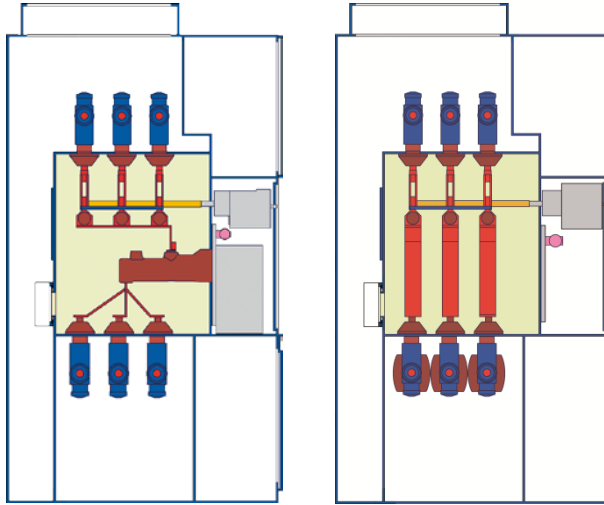

## Panel variants

- Sectionalizer / Riser 1250A

- Sectionalizer / Riser 2000A  
Similarly for 1600A and 2500A

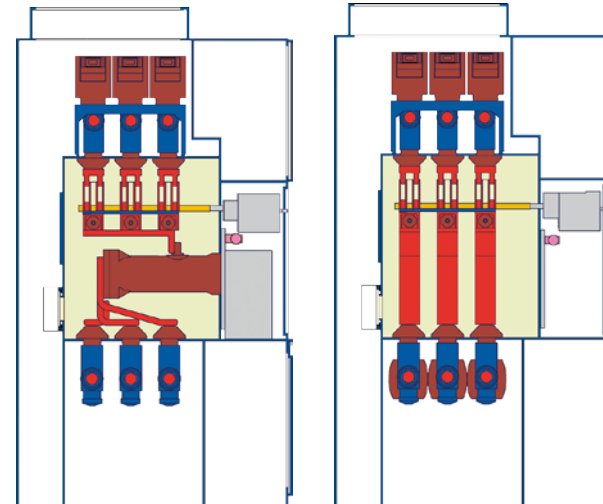

# Gas-insulated switchgear Type ZX0.2

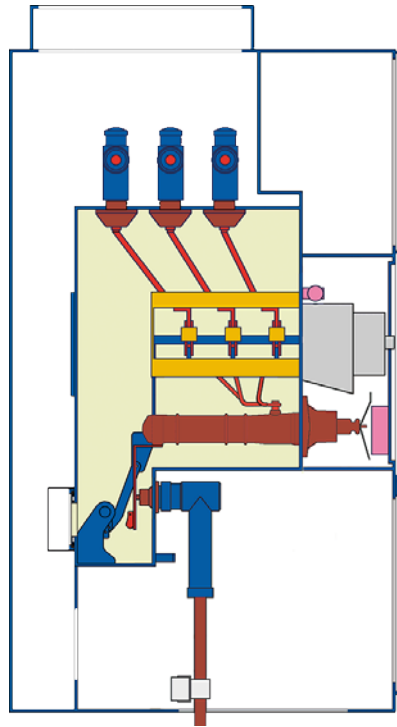

## Panel variants

- Switch-disconnector panel with fuses

Up to 24kV

# Gas-insulated switchgear

## Type ZX0.2



### Advantages

- Partitioned function compartments ► maximum safety
- Completely shockproof arrangement
- High voltage section totally independent of environmental influences
- Maximum availability for the operator
- Independence of the environment makes for extremely long system life
- Minimum maintenance requirement
- Longer life than other system types

Power and productivity  
for a better world™

